

ALTHON Supreme Athlon HD 2000

Technical Data

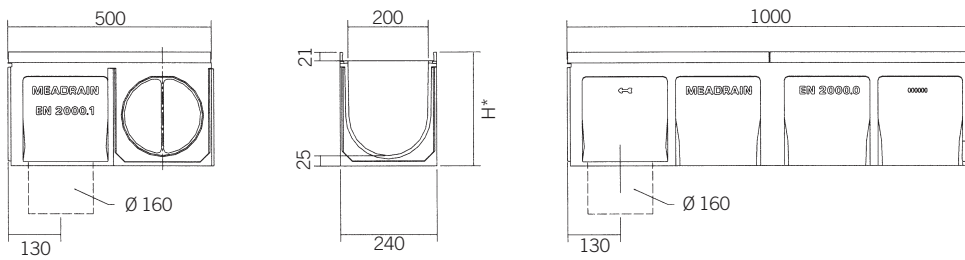

H* = Height

Material properties

Channel body

- ◆ Polymer concrete based on polyester resin
- ◆ Compression resistance: > 90 N/mm²
- ◆ Flexural strength: > 22 N/mm²
- ◆ Water absorption: less than 0,05%
- ◆ Density: 2,1 - 2,3 kg/dm³
- ◆ Modulus of elasticity: 25 - 35 kN/mm²
- ◆ Water penetration level: 0 mm
- ◆ Material structure: capillary free

Edge protection

- ◆ Cast iron: KTL-coated (cataphoretic painting)

Grating

- ◆ Ductile iron

Description and sizes

- ◆ Drainage channel made of polymer concrete with sealable channel groove
- ◆ Approval of DIBt (German institute of technical approvals)
- ◆ Integrated cast iron edge protection
- ◆ Connection facility for vertical discharge Ø 160 in 500 mm and 1000 mm channel
- ◆ The /A-marked channel elements include a HD-PE outlet connector Ø 160
- ◆ Interlocking joint system for an exact fitting of the channels
- ◆ Suitable for installation of MEADRAIN Top 2000 grating covers with PROFIX boltless locking systems or standard locking mechanisms
- ◆ Fall type: stepped fall and without fall
- ◆ Loading classes: A 15 - F 900 to EN 1433 (D 400 unsuitable for cross drainage of high speed roads and motorways)
- ◆ Total height: 280 mm - 380 mm (see table)
- ◆ Total width: 240 mm
- ◆ Length: 500 mm and 1000 mm

Channel units overview

Channel without fall

Product description	Length [mm]	Total height h1 [mm]	Total height h2 [mm]	Weight [kg]	Inlet sectional area** [cm ²]	EDP Number 010...
EN 2000.0 ¹⁾	1000	280	280	37,0	420,0	157531
EN 2000.1 ¹⁾²⁾	500	280	280	19,0	420,0	157533
EN 2010.0 ¹⁾	1000	330	330	42,5	520,0	157535
EN 2010.1 ¹⁾²⁾	500	330	330	21,0	520,0	157537
EN 2020.0 ¹⁾	1000	380	380	47,5	620,0	157539
EN 2020.1 ¹⁾²⁾	500	380	380	23,5	620,0	157541
EN 2020.1RW/A ²⁾³⁾	500	380	380	23,5	620,0	157543

Channel units with stepped fall

as connecting elements for stepped fall (with 5 % fall)

Product description	Length [mm]	Total height h1 [mm]	Total height h2 [mm]	Weight [kg]	Inlet sectional area** [cm ²]	EDP Number 010...
EN 2000-10	1000	280	330	39,0	520,0	157545
EN 2010-20	1000	330	380	43,5	620,0	157547

¹⁾ Channel element suitable for connection to a vertical Ø 160 outlet connector, a silt box or an end cap with outlet connector

²⁾ Channel element suitable for corner and cross junction connection

³⁾ Channel element with HD-PE outlet connector Ø 160 with sealing ring and opened on both sides (change flow direction)

** Cross sectional area from the grating surface to the invert of the channel

Product overview Gully elements

product description	Length [mm]	Total height h [mm]	Weight [kg]	EDP Number 010...
EN 2000 SK-OT	500	430	25,0	157549
SK-ZT	524	350	22,0	154709
SK-UT-Short	524	310	24,0	154711
SK-UT-Long	524	460	33,6	154719

¹⁾ Possibility to use lip sealing ring

Gully made of polymer concrete EN 2000.SK

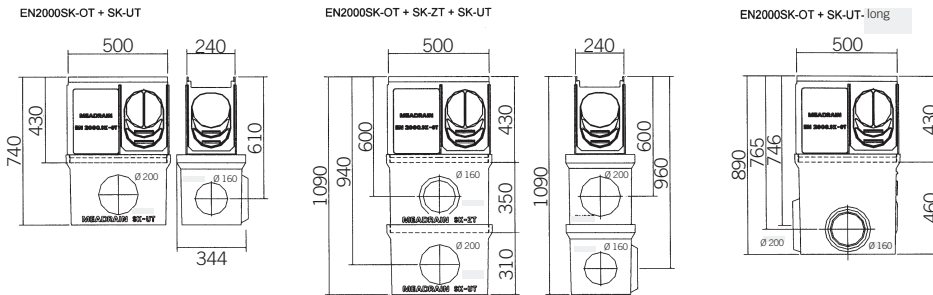

Description and sizes

- ◆ Multipart execution with various possibilities of combination of upper, intermediate and lower parts
- ◆ Integrated cast iron edge protection
- ◆ Galvanized steel sediment bucket available
- ◆ Suitable for installation of MEADRAIN Top 2000 with boltless locking systems or standard locking mechanisms
- ◆ Open both sides for connection of channel type 2000.0
- ◆ Pre-formed knockouts for breaking out, making the perfect connection of the channel types 2010 and 2020
- ◆ Connection facility for outlet connector \varnothing 160 and \varnothing 200.

Sediment bucket for EN 2000.SK-S

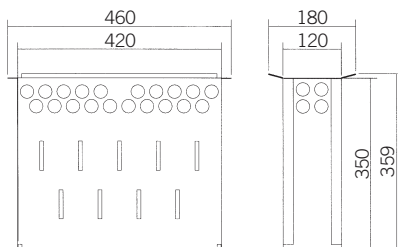

Description and sizes

- ◆ Optimised slot design for achieving best discharge rates
- ◆ Material: galvanized steel

- ◆ EDP-Number: 010154717
- ◆ Total height: 359 mm
- ◆ Total width: 180 mm
- ◆ Total length: 460 mm
- ◆ Weight: 2,5 kg

End caps for channel start and end EN 2000.SE

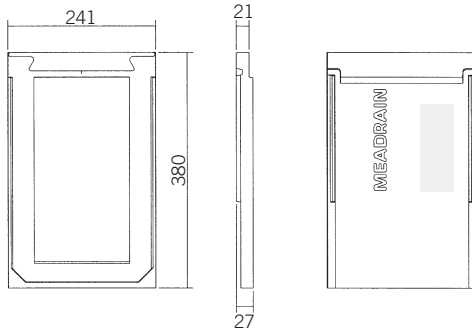

Description and sizes

- ◆ Edge protection: cast iron
- ◆ Suitable for all heights

- ◆ EDP-Number: 010153551
- ◆ Total height: 380 mm
- ◆ Total width: 241 mm

- ◆ Weight: 3,7 kg



End caps for channel end EN 2000.E

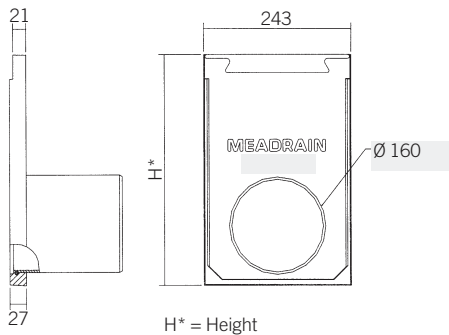

Description and sizes

- ◆ Edge protection: cast iron
- ◆ Integrated sealing ring
- ◆ Integrated HD-PE outlet connector Ø 160
- ◆ Suitable for channel types 2000, 2010 and 2020

	EN 2000.E	EN 2010.E	EN 2020.E
◆ EDP-Number:	010153553	010153555	010153557
◆ Total height:	280 mm	330 mm	380 mm
◆ Total width:	243 mm	243 mm	243 mm
◆ Weight:	2,8 kg	3,3 kg	3,9 kg

Supreme Loading class D 400*

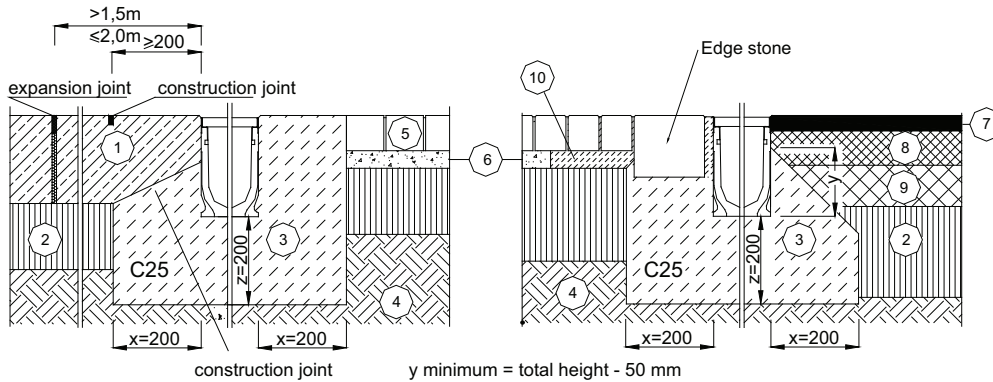

Supreme Loading class E 600

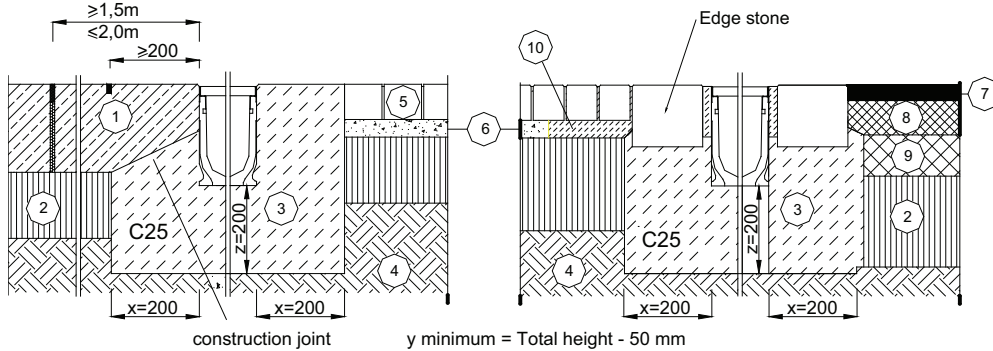

Supreme Loading class F 900

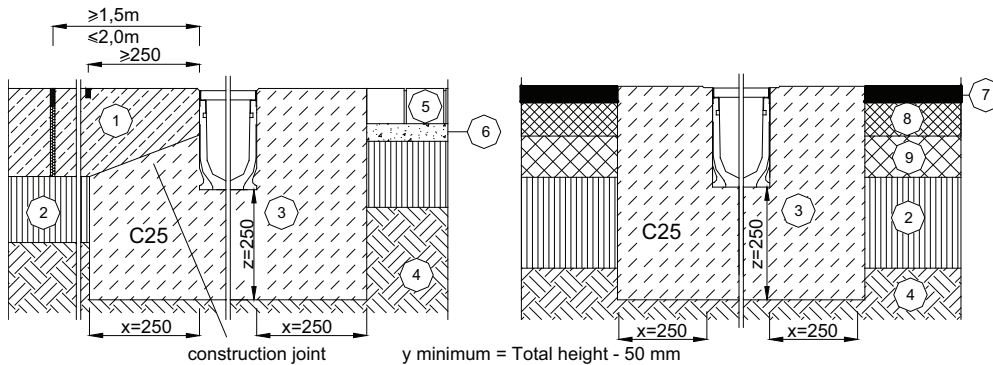

- | | |
|-------------------|--------------------------|
| ① Concrete | ⑥ Sand layer |
| ② Sub-base | ⑦ Asphalt |
| ③ Concrete haunch | ⑧ Base course |
| ④ Earth | ⑨ Bituminous base course |
| ⑤ Block paving | ⑩ Mortar |

The adjacent surfaces to the channels are to be constructed in such a way that no horizontal forces affect the channel items. Please allow for an overbuild of 3-5mm above the grating surface.

*D 400 unsuitable for cross drainage of high speed roads and motorways